

Annex A: Figures

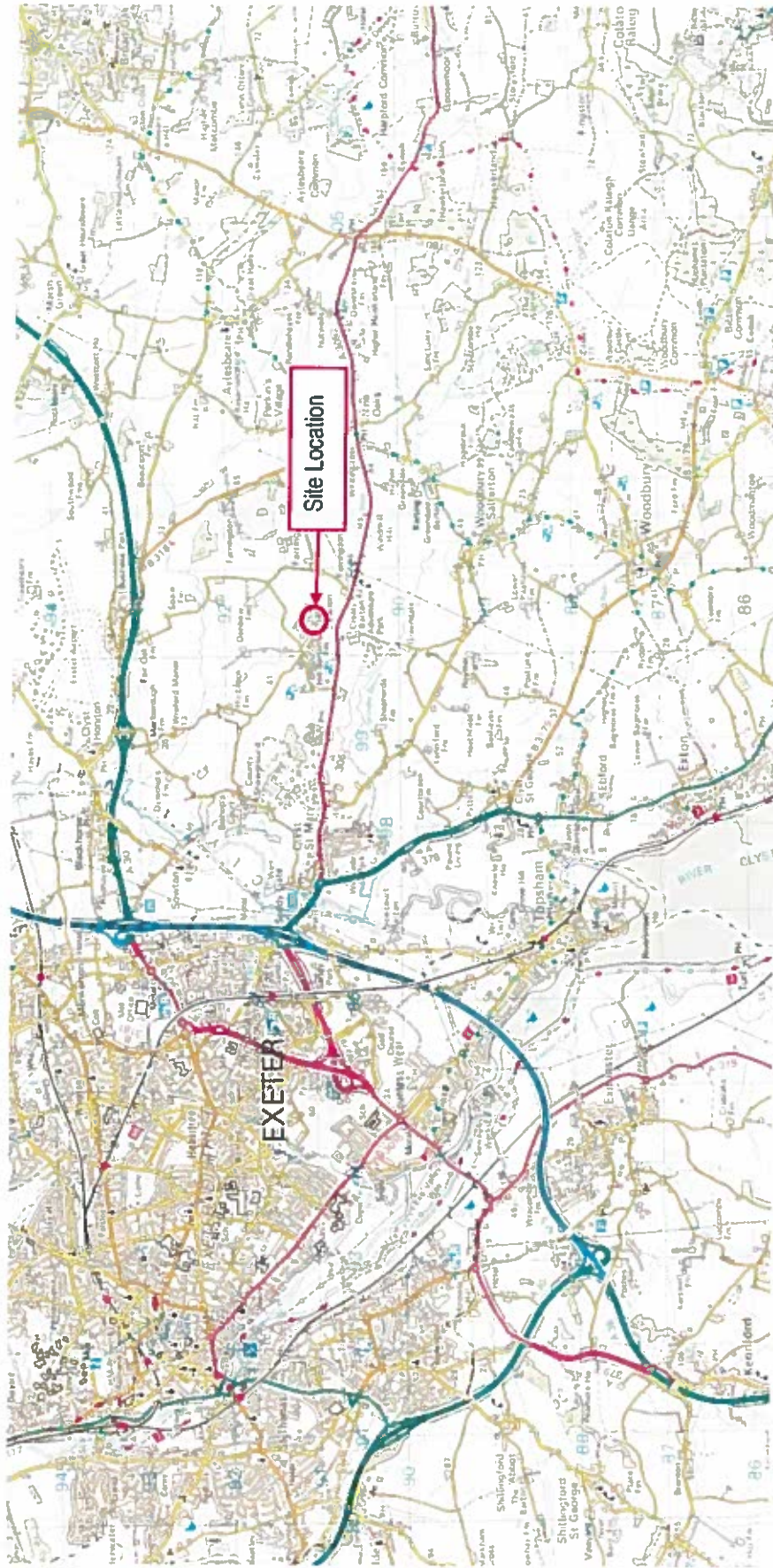

1. Do not scale off this drawing
 2. All dimensions to be confirmed on site
 3. This drawing is copyright of Sol Environment Ltd
 4. This drawing is to be read in conjunction with relevant consultant drawings and specifications

Rev: 0
 Date: NOV 15
 Desc: Original

Client: RENEWABLE ASSET LTD
 Project: WASTE WOOD CHIP FACILITY
 Drawing Title: SITE LOCATION

Job No: SOL1510RA0101
 Date: NOV 15
 Drawn By: SOPHIE PERRI

Drawing No: RA01
 Revision: 0
 Scale: NTS

Sol Environment Ltd
 2nd Floor
 10 The Lees, Malvern,
 Worcestershire WR14 3HT
 t: +44(0)1684 572727
 e: enquiries@sol-environment.co.uk
www.sol-environment.co.uk



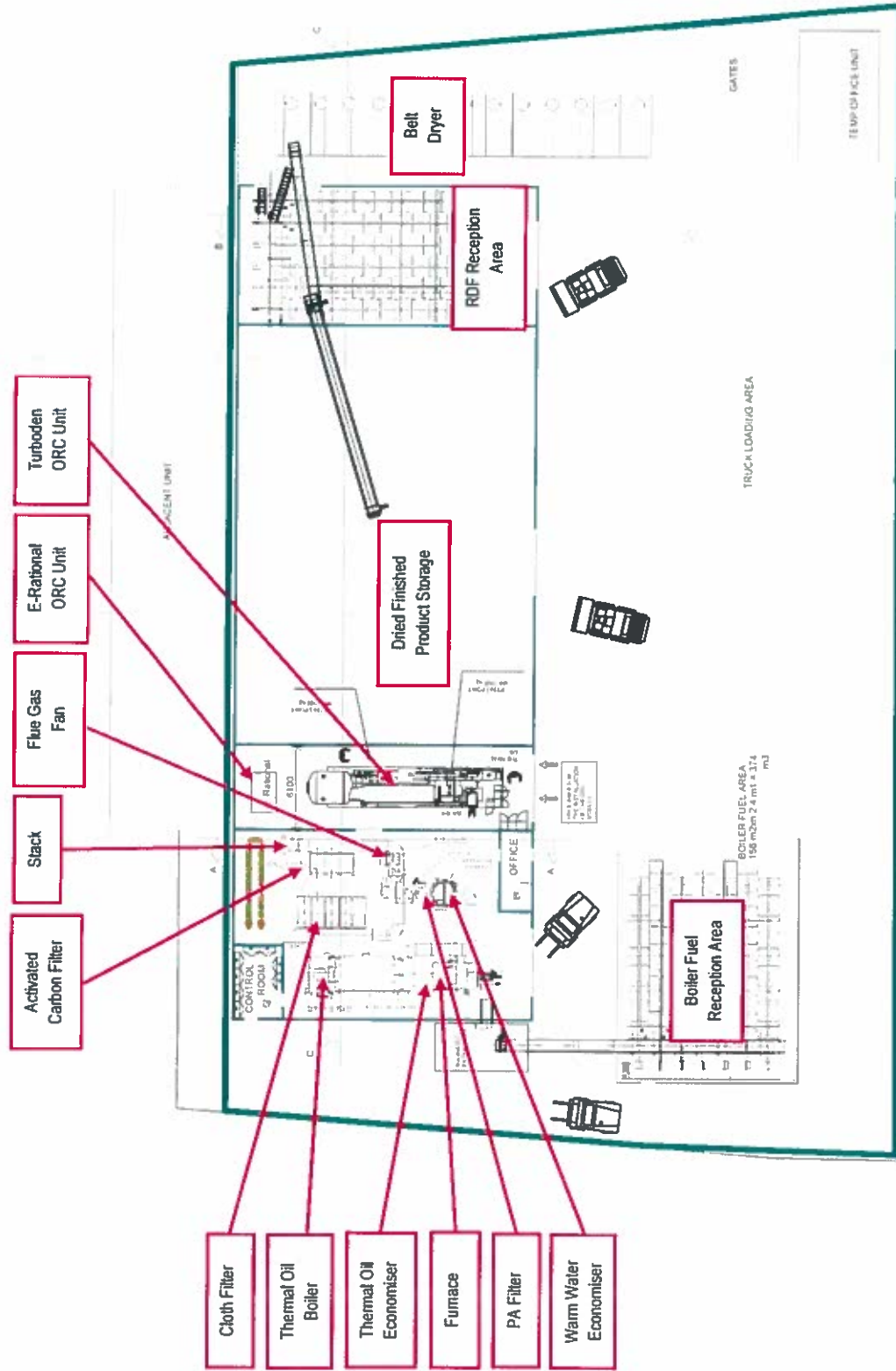

1. Do not scale off this drawing
2. All dimensions to be confirmed on site
3. This drawing is copyright of Sol Environment Ltd
4. This drawing is to be read in conjunction with relevant consultant drawings and specifications

Rev:	Date:	Desc:	Client:	Job No.:
0	NOV 15	Original	RENEWABLE ASSET LTD	SOL1510R4D101

Project:	Date:	Drawn By:
WASTE WOOD CHIP FACILITY	NOV 15	SOPHIE PERRIN

Drawing No:	RA02
Revision:	0
Scale:	MTS





ADJACENT UNIT

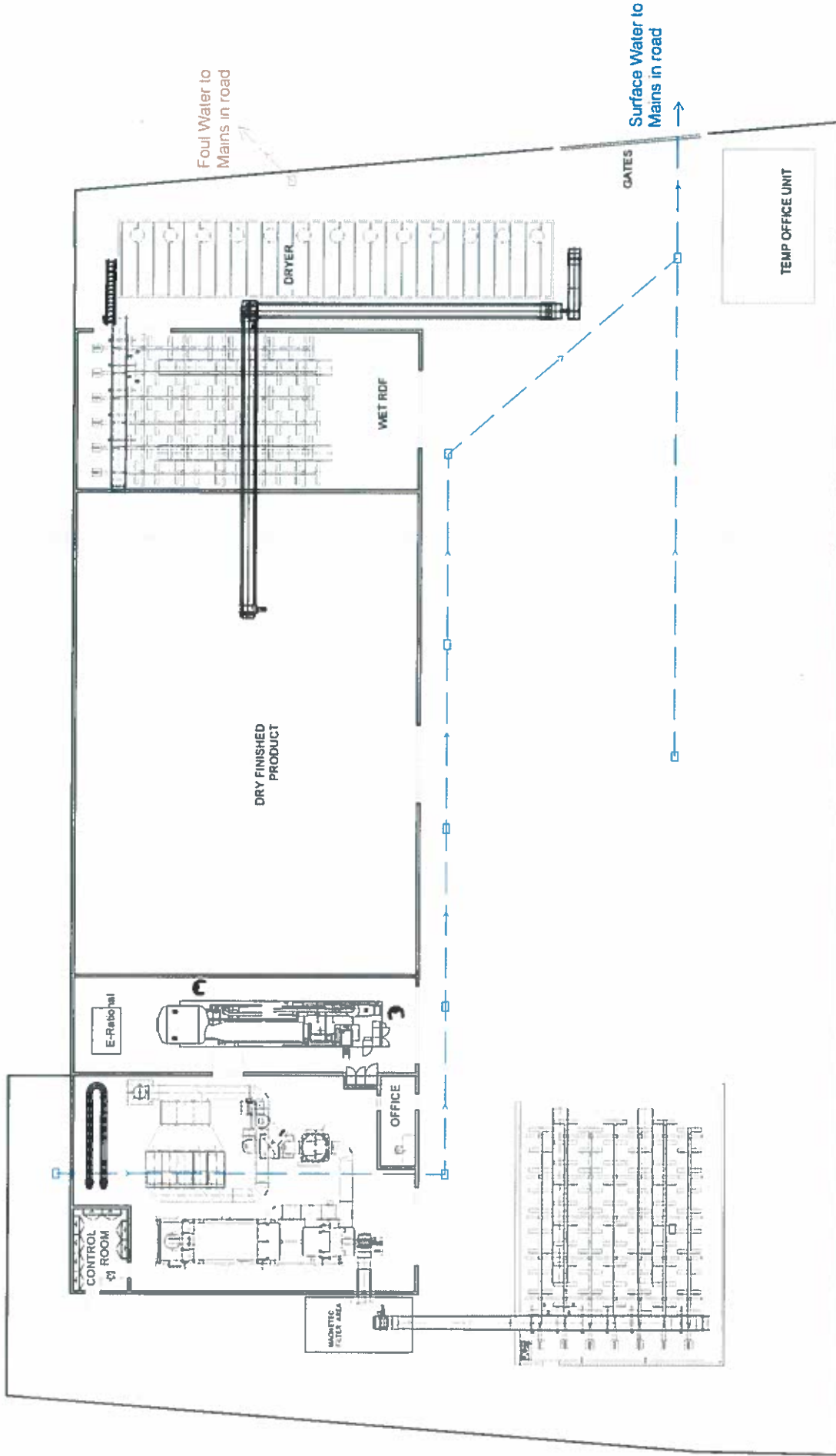

Do not scale from this drawing. All dimensions to be checked on site.

Drawn: AM Date: 30/11/2015 Scale: 1:250@A3



Unit 8 - Hillbarton
 Clyst St Mary
 Proposed Drainage Layout
 DRAWING No. 103/30

HEMYOCK
ENGINEERING
 JEWELS, HEMYOCK, DEVON, EX15 3PX

